



■ GTX Series

5 Axis Simultaneous Machining Center



FINETECH MACHINE TOOL CO., LTD.

No.98 Lane 22, Sec 1, Hsin Jen Rd., Taiping Dist., Taichung City, Taiwan.

TEL: 886-4-2278 3514 FAX: 886-4-2278 3781

E-mail: ft@finetech.com.tw



▶ [http:// www.finetech.com.tw](http://www.finetech.com.tw)

06-2017/1000 06-035E/S
Sumway 04-2322 7907

FINETECH MACHINE TOOL CO., LTD.

E-mail: ft@finetech.com.tw

GTX-620

5 Axes Simultaneous Control

Easy loading of workpiece, efficient swarf management, good operating ergonomics all axes servo driven, encoder feedback on all axes, optional auto door, optional workpiece clamping (oil/air), optional ball screw nut, cooling, finite analysis design, high rigidity cast construction.

THK linear guideway (JAPAN) X, Y, Z.

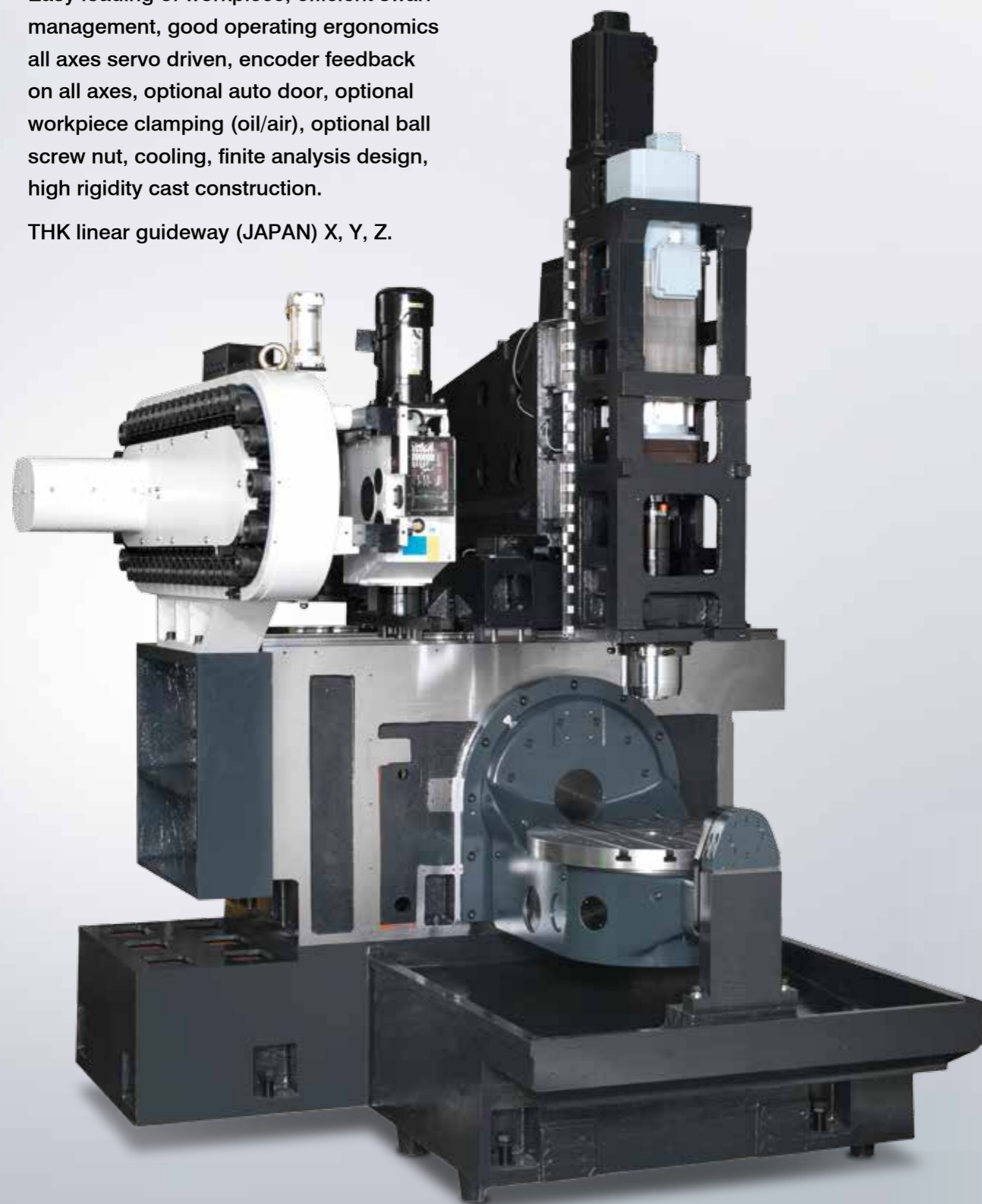

Customer can choose a different drive method on B/C axes

- Cam Drive (Standard)
- Worm Drive
- Direct Drive



GTX-1520 / 2520

High Efficiency 5 Axes Machining Center Ergonomic Design

Front and side access for easy loading and operation

Efficient swarf management

Encoders on all axes

THK roller guideway (JAPAN) X, Y, Z 45mm.

Double nut ballscrew, liquid cooled, choice of Arm type ATC

24 / 30 / 32 / 40 / 48 / 54 / 60 position ATC



Flexible design, double work table may be used as a 4+1 or 5 axes machine easy to machine extra long workpiece high load capacity on fixed table.

Fixed work table may be fitted with various accessories, tailstock for shaft machining center.

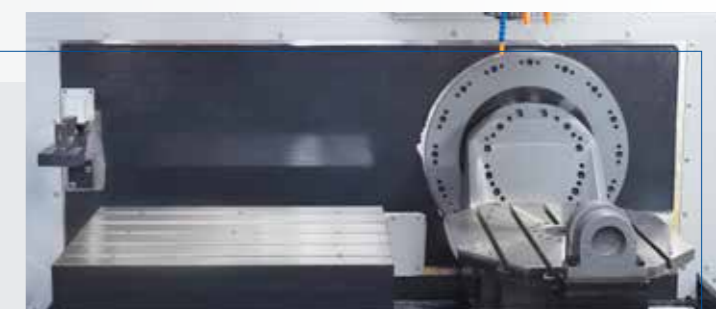

GTX-210 / 320

C Frame 5 Axes Machining Center

Extremely versatile 5 axes machining center C frame construction.

Air counter balance system on Z-axis, encoders on all axes and roller guideways on X, Y, Z axes



Quick return on investment due to performance a / cost ratio ultra modern ergonomic design as with all Finetech machines built to the highest standards.



B/C Axis Rotations

Rotary Tilt Table

The precision rotary tilt table allows for either 3+2 or 5 axis simultaneous machining.

- Optical encoders standard for B and C axes.
- Table tilt angle (B-axis): $-40^{\circ} \sim +110^{\circ}$.
- Table rotary angle (C-axis): 360° continuous rotation.
- B and C axes are servo motor driven.



B axis at 0°

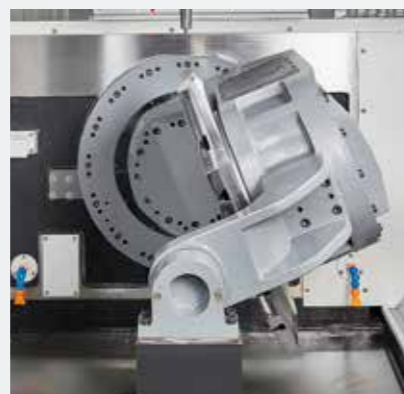

B axis at 110°



B axis at -40°

Laser Calibration



X, Y, Z, B, C axes are laser calibrated for linear positioning and angular accuracy.



Fully Enclosed



24 / 30 / 32 / 40 / 48 / 54 / 60 Position ATC



Electrical cabinet



Spindle oil cooler



Stainless steel water proof cover

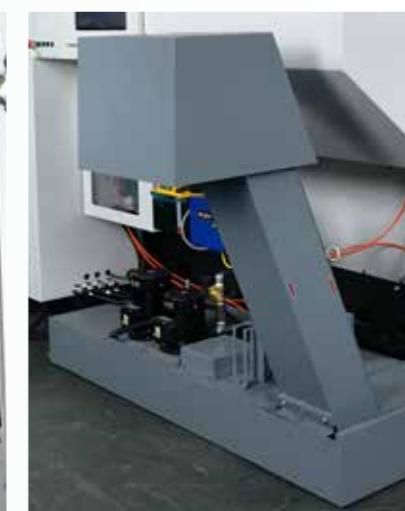

Efficient swarf removal system

Optional Accessories

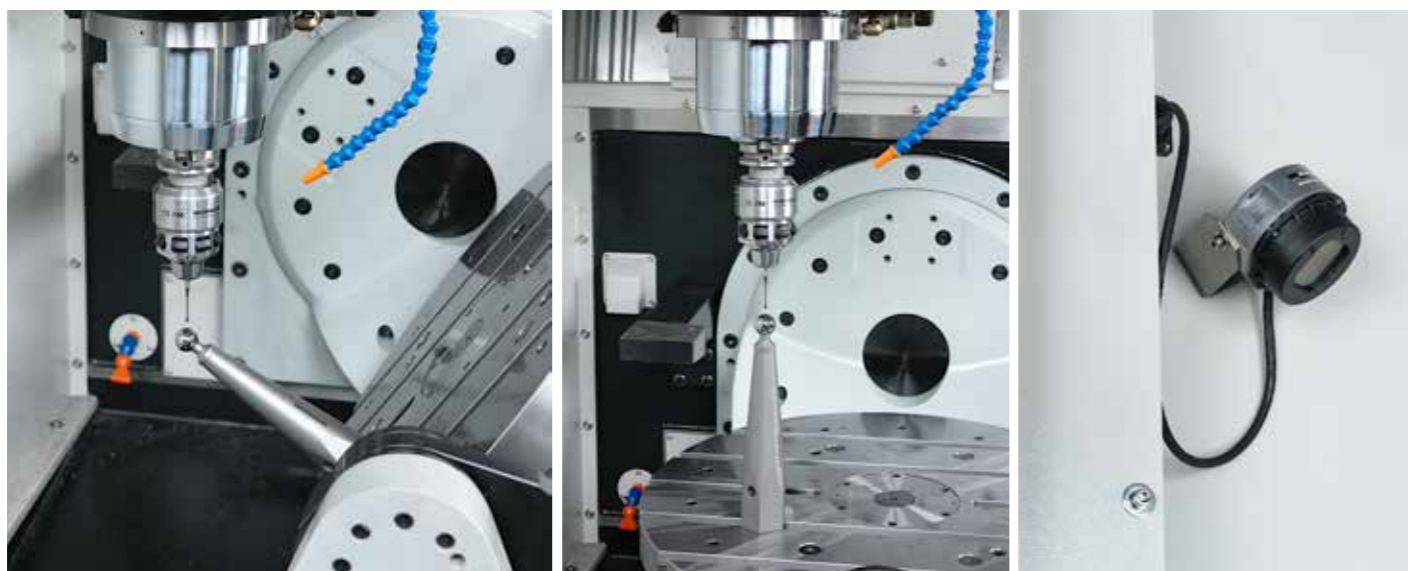

Heidenhain TT740+KKH100(250) infrared probe for automatic kinematic measurement and calibration of 5-axis positioning.



20~100 Bars CTS system



Heidenhain TT160



X / Y / Z Linear Scale



Low Profile Design



Laser Tool Measurement System



B / C Axes Encoder

GTX-1520

X-Axis Tilt Travel

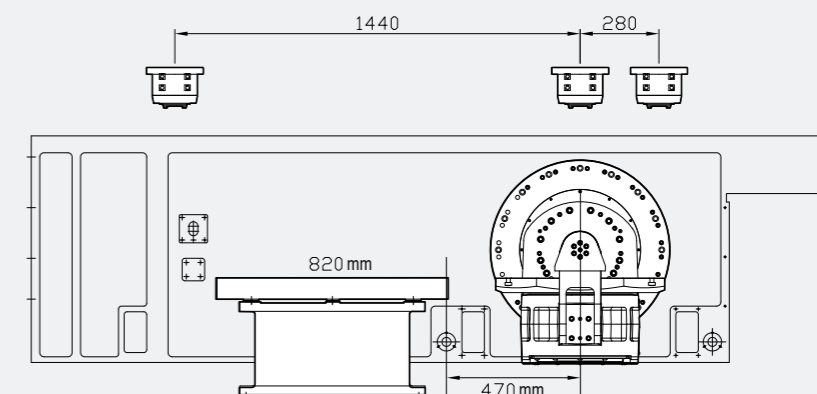

B-Axis Tilt Travel

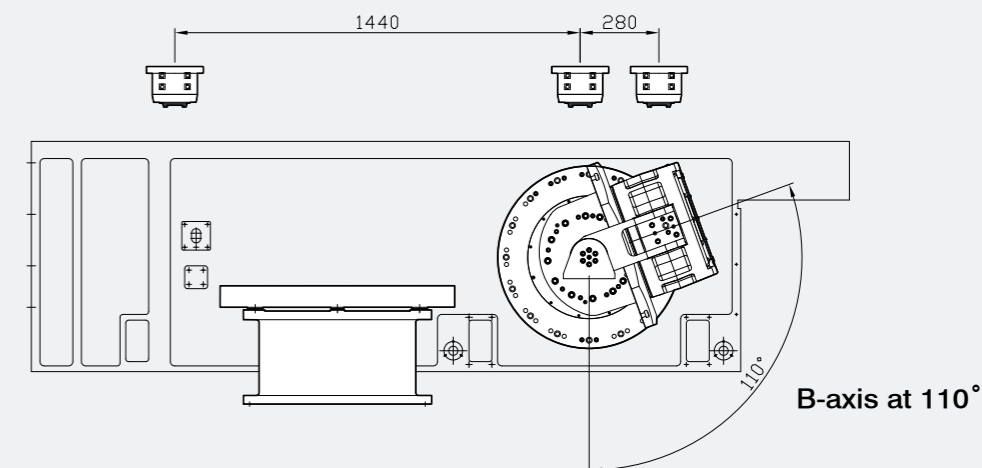

B-Axis Tilt Travel

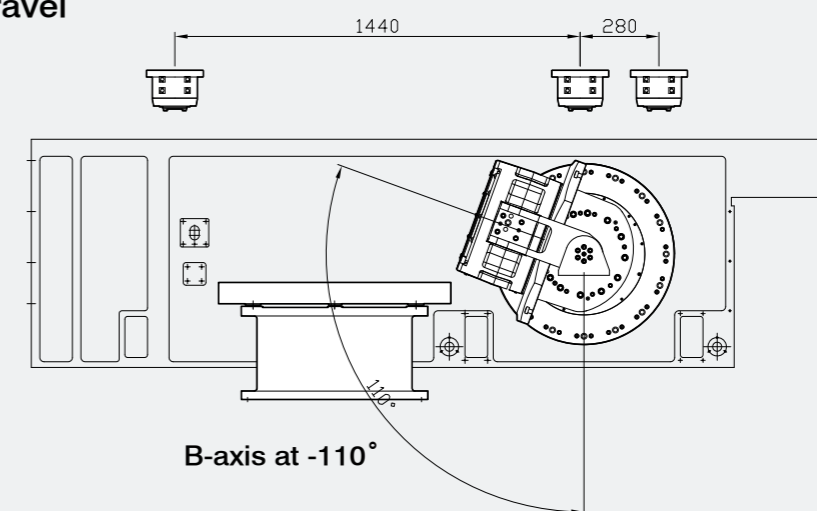

TABLE DIMENSION (LCM)

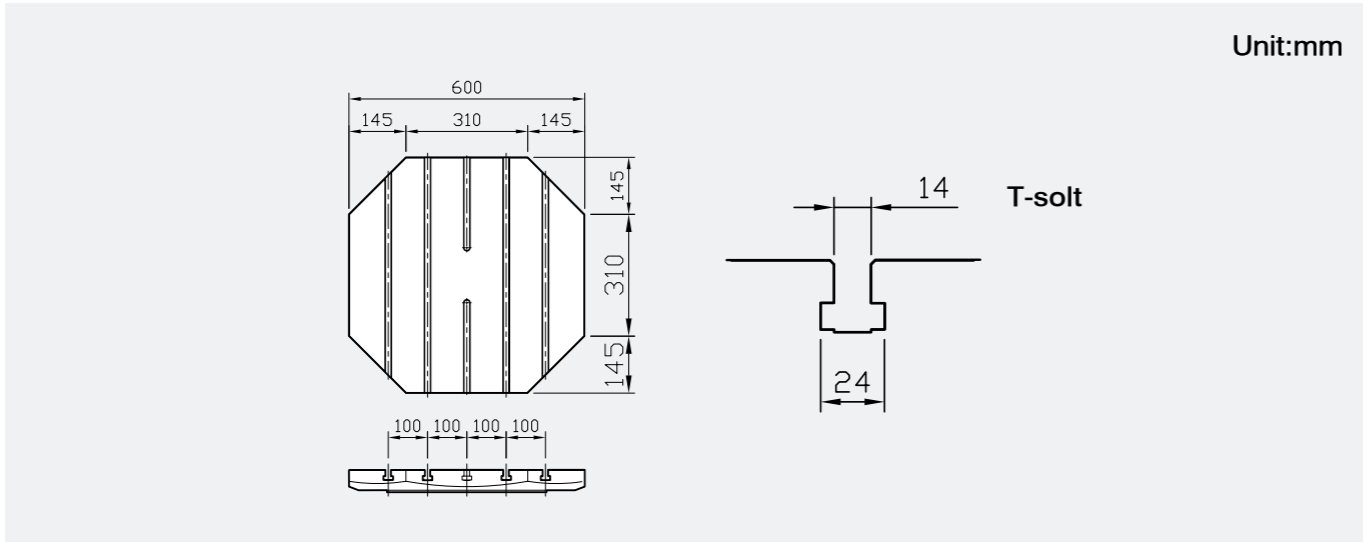
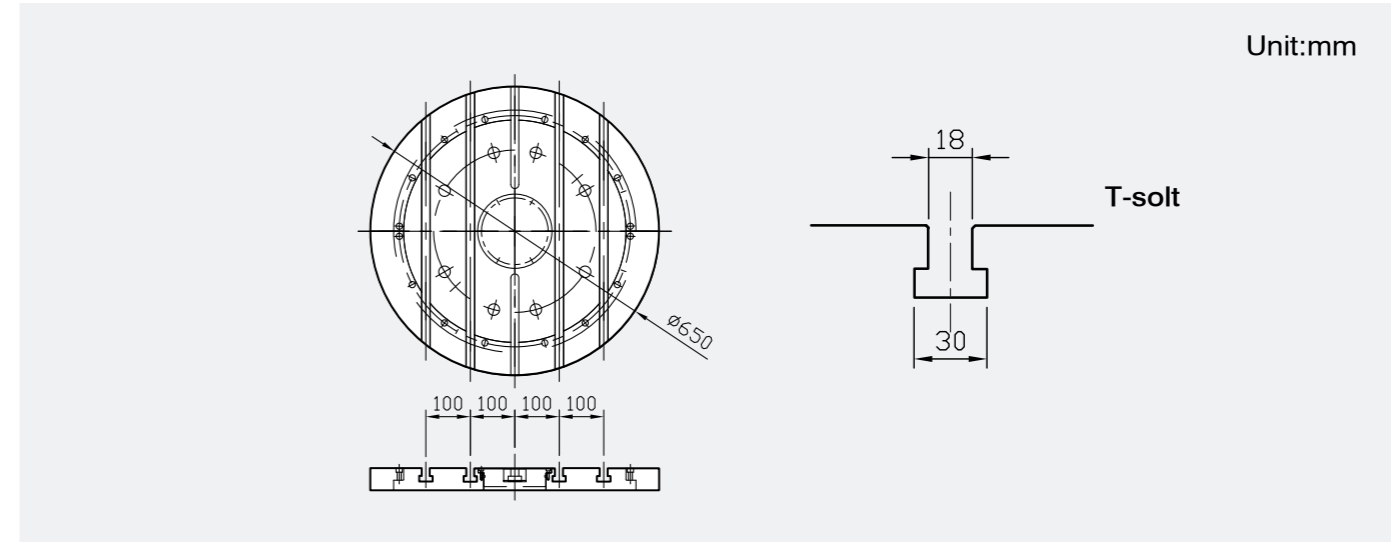
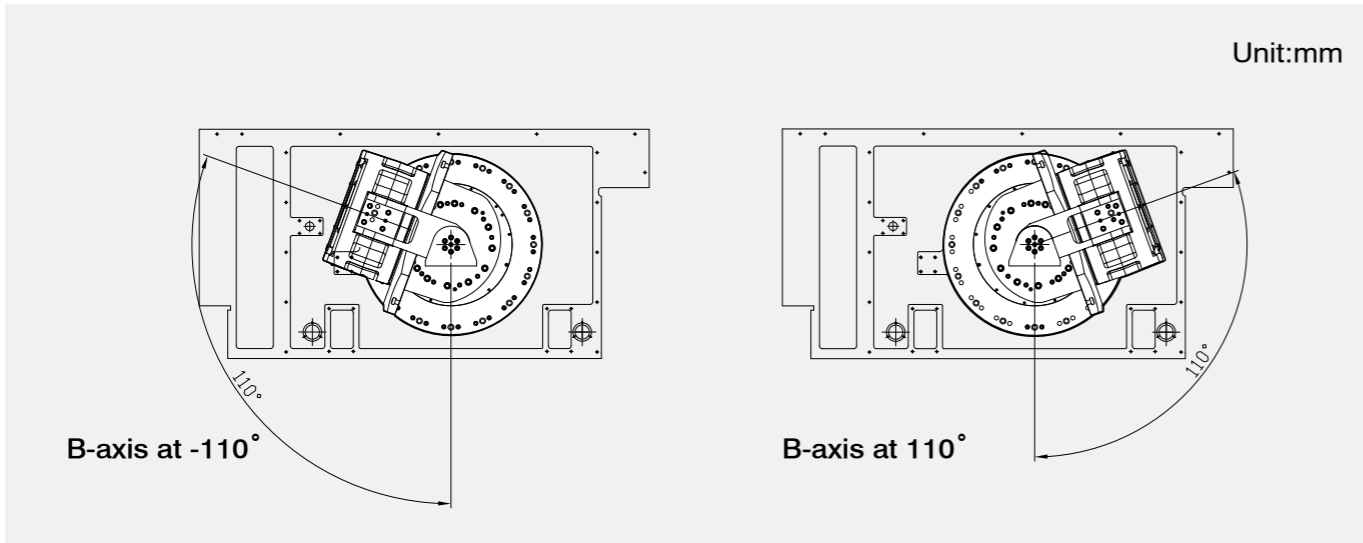

TABLE DIMENSION (GTX-620)



B-AXIS TRAVEL



B-AXIS TRAVEL

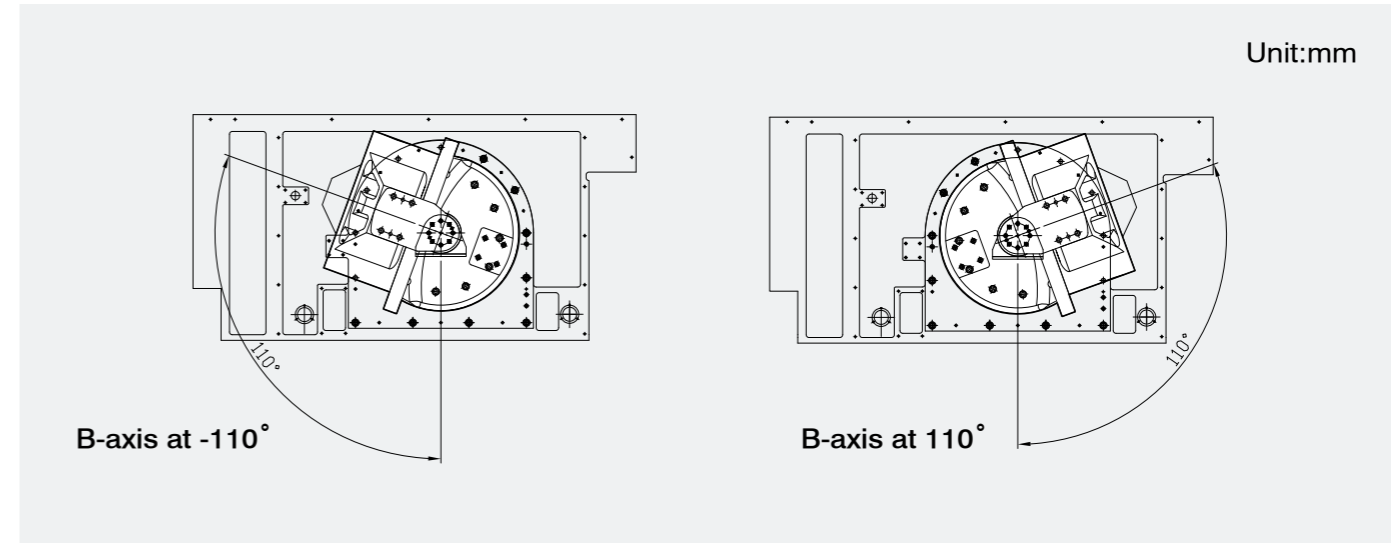

X / Y-AXIS TRAVEL

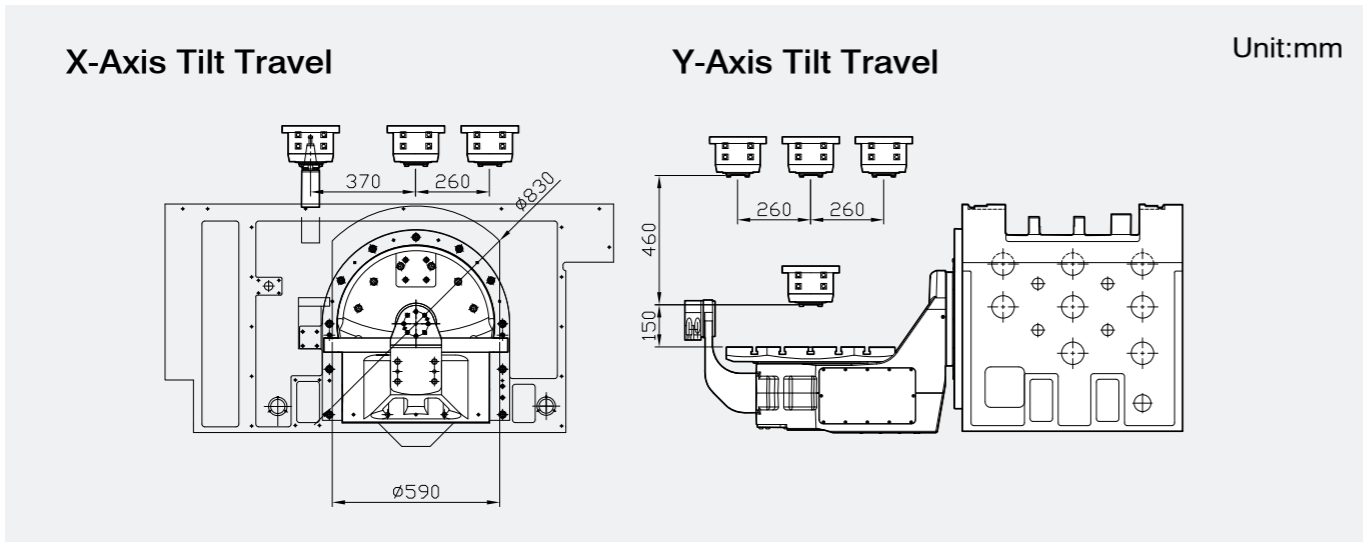

X / Y-AXIS TRAVEL

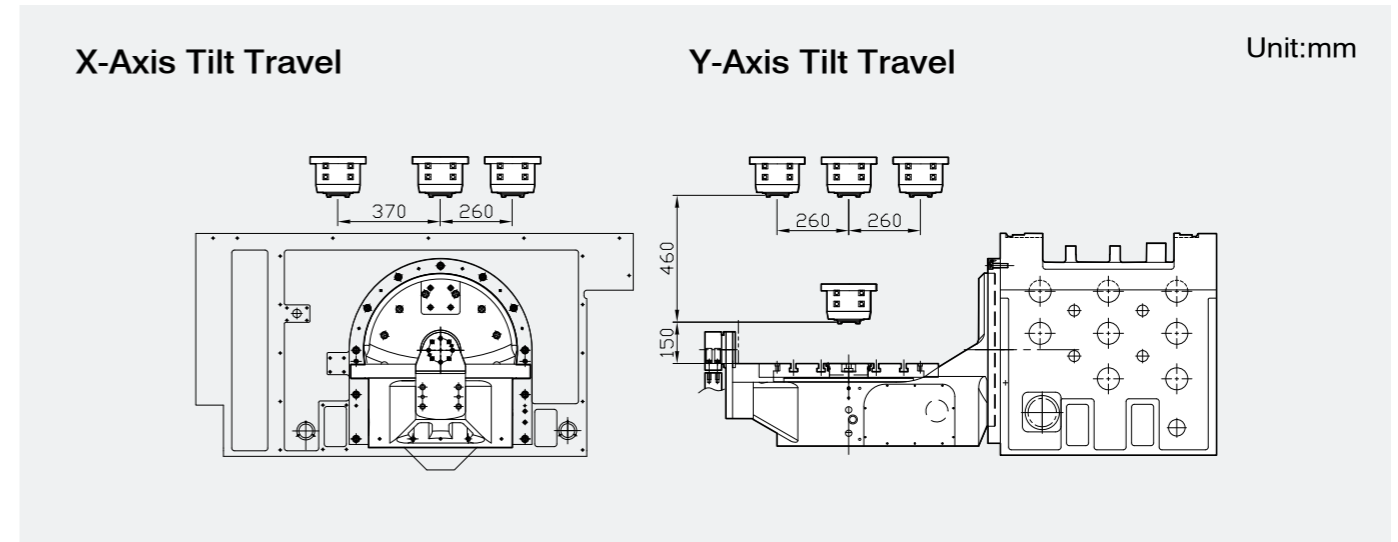

5 Axes Machining Center Specification

Machine Specification	GTX-620	GTX-1520	GTX-2520	GTX-210	GTX-320
Travel					
X / Y / Z travel	620 / 520 / 460 mm	1570/520/460	2570/520/460	350 / 450 / 410 mm	900/600/510
B-axis tilt range	-40° ~ 110°	-40° ~ 110°	-40° ~ 110°	-40° ~ 110°	-40° ~ 110°
C-axis rotation angle	360°	360°	360°	360°	360°
Max. workpiece size	ø520 x 330L	ø520 x 330L	ø520 x 330L	ø200*160L	ø200*310L
Spindle nose to work table	150 - 610 mm	150 - 610 mm	150 - 610 mm	0 - 410mm	100-610mm
Axes Feedrates					
X / Y / Z-axis	36 m/min	36 m/min	36 m/min	36 m/min	36 m/min

B/C Specification					
C-axis work table dia.	ø500 / ø600 / ø650 mm	ø500 / ø600 / ø650 mm	ø500 / ø600 / ø650 mm	ø210	ø310
Centering hole dia.	ø50H7	ø50H7	ø50H7	Ø40H7	Ø70H7
T slot	Standard	18H8 mm x 5	14H7 mm x 5	14H7 mm x 5	12H7 mm*1
	Optional	14H7 mm x 5			
Work table Max.	B axis	25 / 50 / 50 rpm	25 / 50 / 50 rpm	25 / 50 / 50 rpm	25 rpm
	C axis	25 / 100 / 1000 rpm	25 / 100 / 1000 rpm	25 / 100 / 1000 rpm	25 rpm
Max. workpiece weight	300~500 kgs	300~500kgs	300~500kgs	50~75 kgs	150~200 kgs

• All specifications, dimensions and design characteristics shown in this catalogue are subject to change without notice.

Standard Equipment :

- Spindle speed 12000rpm
- Spindle oil chiller
- Spindle bearing purge
- Programmable cutting air blast system
- Coolant gun
- Air gun
- Full enclosed splash guard
- Large table size 650mm
- Interlock front/ side door
- Mechanical oil/coolant separator
- Automatic tool changer
- Spindle taper: #40(DIN, BT, CAT)
- 32 station tool magazine
- Roller linear guideways
- Z-axis motor with brake system
- LED lamp
- M30 power off
- Heat exchanger for electrical cabinet
- Tailstock for GTX-1520 / 2520

Optional Equipment :

- Coolant Through Spindle (CTS)
- Programmable cutting coolant nozzle
- Coolant cooling system
- Chain type chip conveyor
- Chip cart
- Chip flushing system
- Laser tool length measurement system TL Micro 200
- Contact type tool length measurement system TT160
- Workpiece measurement kinematic system TT740+KKH100(250)
- Air supply for clamping fixture
- CE conformity specification
- Round metal plate type oil skimmer
- X / Y / Z optical linear scale
- B / C-axis optical encoder
- Air conditioner for electrical cabinet
- Transformer
- HSK 63 20,000rpm spindle (Built-in type)
- 15000rpm direct driven spindle
- Software for crash protection